



ワシ刃採用
スクイ角・刃底R大

TAIYO

T-STKC

(ハイス 強力型キーシードカッター TiCN SKH51)



特徴

1. **ワシ刃採用による切削性の向上が、バリを抑える！**
2. **TiCNコーティングにより、耐摩耗性に優れる！**
3. **ハイスソリッド(塑性一体成形材)を使用。**

	非鉄金属 Al/Cu	鋳鉄 FG/FCD	炭素鋼 S50C	合金鋼 SCM	工具鋼 SKD	ステンレス鋼 SUS	調質硬 HPM/NAK
T-STKC	◎	○	◎	○	○	△	—



▼ T-STKC CAD図

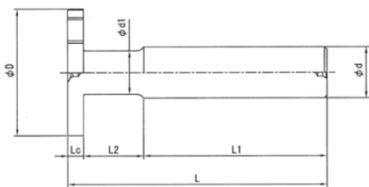

形状A

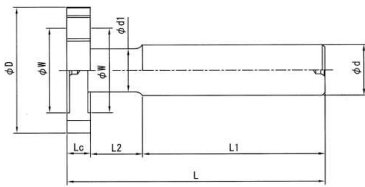

形状B

スキ角 15°

■外径許容差

φ10~30 0~+0.05

φ35~50 0~+0.07

■刃幅許容差

φ10~30 -0.012~0

φ35~50 -0.018~0

▼ T-STKC 寸法表

(単位:mm)

外径 φD	刃幅 Lc	首径 φd1	首長 L2	全長 L	柄径 φd	刃数 N	形状
10	0.4	4	14.6	50	10	8	A
10	0.5	4	14.5	50	10	8	A
10	0.6	4	14.4	50	10	8	A
10	0.7	4	14.3	50	10	8	A
10	0.8	4	14.2	50	10	8	A
10	0.9	4	14.1	50	10	8	A
10	1	4	14	50	10	8	A
10	1.1	4	13.9	50	10	8	A
10	1.2	4	13.8	50	10	8	A
10	1.3	4	13.7	50	10	8	A
10	1.4	4	13.6	50	10	8	A
10	1.5	4	13.5	50	10	8	A
10	1.6	4	13.4	50	10	8	A
10	1.7	4	13.3	50	10	8	A
10	1.8	4	13.2	50	10	8	A
10	1.9	4	13.1	50	10	8	A
10	2	4	13	50	10	8	A
10	2.1	4	12.9	50	10	8	A
10	2.2	4	12.8	50	10	8	A
10	2.3	4	12.7	50	10	8	A
10	2.4	4	12.6	50	10	8	A
10	2.5	4	12.5	50	10	8	A
10	2.6	4	12.4	50	10	8	A
10	2.7	4	12.3	50	10	8	A
10	2.8	4	12.2	50	10	8	A
10	2.9	4	12.1	50	10	8	A
10	3	4	12	50	10	8	A
10	3.5	4	11.5	50	10	8	A
10	4	4	11	50	10	8	A
10	4.5	4	10.5	50	10	8	A
10	5	4	10	50	10	8	A
12	0.4	4.5	14.6	55	12	10	A
12	0.5	4.5	14.5	55	12	10	A
12	0.6	4.5	14.4	55	12	10	A
12	0.7	4.5	14.3	55	12	10	A
12	0.8	4.5	14.2	55	12	10	A
12	0.9	4.5	14.1	55	12	10	A
12	1	4.5	14	55	12	10	A
12	1.1	4.5	13.9	55	12	10	A
12	1.2	4.5	13.8	55	12	10	A
12	1.3	4.5	13.7	55	12	10	A
12	1.4	4.5	13.6	55	12	10	A
12	1.5	4.5	13.5	55	12	10	A
12	1.6	4.5	13.4	55	12	10	A
12	1.7	4.5	13.3	55	12	10	A
12	1.8	4.5	13.2	55	12	10	A
12	1.9	4.5	13.1	55	12	10	A
12	2	4.5	13	55	12	10	A
12	2.1	4.5	12.9	55	12	10	A
12	2.2	4.5	12.8	55	12	10	A
12	2.3	4.5	12.7	55	12	10	A
12	2.4	4.5	12.6	55	12	10	A
12	2.5	4.5	12.5	55	12	10	A
12	2.6	4.5	12.4	55	12	10	A
12	2.7	4.5	12.3	55	12	10	A
12	2.8	4.5	12.2	55	12	10	A
12	2.9	4.5	12.1	55	12	10	A
12	3	4.5	12	55	12	10	A
12	3.5	4.5	11.5	55	12	10	A
12	4	4.5	11	55	12	10	A
12	4.5	4.5	10.5	55	12	10	A
12	5	4.5	10	55	12	10	A
15	0.4	5.5	17.6	58	15	10	A
15	0.5	5.5	17.5	58	15	10	A
15	0.6	5.5	17.4	58	15	10	A
15	0.7	5.5	17.3	58	15	10	A
15	0.8	5.5	17.2	58	15	10	A
15	0.9	5.5	17.1	58	15	10	A
15	1	5.5	17	58	15	10	A
15	1.1	5.5	16.9	58	15	10	A
15	1.2	5.5	16.8	58	15	10	A
15	1.3	5.5	16.7	58	15	10	A
15	1.4	5.5	16.6	58	15	10	A
15	1.5	5.5	16.5	58	15	10	A
15	1.6	5.5	16.4	58	15	10	A
15	1.7	5.5	16.3	58	15	10	A
15	1.8	5.5	16.2	58	15	10	A
15	1.9	5.5	16.1	58	15	10	A
15	2	5.5	16	58	15	10	A
15	2.1	5.5	15.9	58	15	10	A
15	2.2	5.5	15.8	58	15	10	A
15	2.3	5.5	15.7	58	15	10	A
15	2.4	5.5	15.6	58	15	10	A
15	2.5	5.5	15.5	58	15	10	A
15	2.6	5.5	15.4	58	15	10	A
15	2.7	5.5	15.3	58	15	10	A
15	2.8	5.5	15.2	58	15	10	A
15	2.9	5.5	15.1	58	15	10	A
15	3	5.5	15	58	15	10	A
15	3.5	5.5	14.5	58	15	10	A
15	4	5.5	14	58	15	10	A
15	4.5	5.5	13.5	58	15	10	A
15	5	5.5	13	58	15	10	A

外径 φD	刃幅 Lc	首径 φd1	首長 L2	全長 L	柄径 φd	刃数 N	形状
15	1.9	5.5	16.1	60	15	10	A
15	2	5.5	16	60	15	10	A
15	2.1	5.5	15.9	60	15	10	A
15	2.2	5.5	15.8	60	15	10	A
15	2.3	5.5	15.7	60	15	10	A
15	2.4	5.5	15.6	60	15	10	A
15	2.5	5.5	15.5	60	15	10	A
15	2.6	5.5	15.4	60	15	10	A
15	2.7	5.5	15.3	60	15	10	A
15	2.8	5.5	15.2	60	15	10	A
15	2.9	5.5	15.1	60	15	10	A
15	3	5.5	15	60	15	10	A
15	3.5	5.5	14.5	60	15	10	A
15	4	5.5	14	60	15	10	A
15	4.5	5.5	13.5	60	15	10	A
15	5	5.5	13	60	15	10	A
16	0.4	6	17.6	60	16	12	A
16	0.5	6	17.5	60	16	12	A
16	0.6	6	17.4	60	16	12	A
16	0.7	6	17.3	60	16	12	A
16	0.8	6	17.2	60	16	12	A
16	0.9	6	17.1	60	16	12	A
16	1	6	17	60	16	12	A
16	1.1	6	16.9	60	16	12	A
16	1.2	6	16.8	60	16	12	A
16	1.3	6	16.7	60	16	12	A
16	1.4	6	16.6	60	16	12	A
16	1.5	6	16.5	60	16	12	A
16	1.6	6	16.4	60	16	12	A
16	1.7	6	16.3	60	16	12	A
16	1.8	6	16.2	60	16	12	A
16	1.9	6	16.1	60	16	12	A
16	2	6	16	60	16	12	A
16	2.1	6	15.9	60	16	12	A
16	2.2	6	15.8	60	16	12	A
16	2.3	6	15.7	60	16	12	A
16	2.4	6	15.6	60	16	12	A
16	2.5	6	15.5	60	16	12	A
16	2.6	6	15.4	60	16	12	A
16	2.7	6	15.3	60	16	12	A
16	2.8	6	15.2	60	16	12	A
16	2.9	6	15.1	60	16	12	A
16	3	6	15	60	16	12	A
16	3.5	6	14.5	60	16	12	A
16	4	6	14	60	16	12	A
16	4.5	6	13.5	60	16	12	A
16	5	6	13	60	16	12	A
18	0.4	6.5	17.6	60	18	12	A
18	0.5	6.5	17.5	60	18	12	A
18	0.6	6.5	17.4	60	18	12	A
18	0.7	6.5	17.3	60	18	12	A
18	0.8	6.5	17.2	60	18	12	A
18	0.9	6.5	17.1	60	18	12	A
18	1	6.5	17	60	18	12	A
18	1.1	6.5	16.9	60	18	12	A
18	1.2	6.5	16.8	60	18	12	A
18	1.3	6.5	16.7	60	18	12	A
18	1.4	6.5	16.6	60	18	12	A
18	1.5	6.5	16.5	60	18	12	A
18	1.6	6.5	16.4	60	18	12	A
18	1.7	6.5	16.3	60	18	12	A
18	1.8	6.5	16.2	60	18	12	A
18	1.9	6.5	16.1	60	18	12	A
18	2	6.5	16	60	18	12	A
18	2.1	6.5	15.9	60	18	12	A
18	2.2	6.5	15.8	60	18	12	A
18	2.3	6.5	15.7	60	18	12	A
18	2.4	6.5	15.6	60	18	12	A
18	2.5	6.5	15.5	60	18	12	A
18	2.6	6.5	15.4	60	18	12	A
18	2.7	6.5	15.3	60	18	12	A
18	2.8	6.5	15.2	60	18	12	A
18	2.9	6.5	15.1	60	18	12	A
18	3	6.5	15	60	18	12	A
18	3.5	6.5	14.5	60	18	12	A
18	4	6.5	14	60	18	12	A
18	4.5	6.5	13.5	60	18	12	A
18	5	6.5	13	60	18	12	A

外径 φD	刃幅 Lc	首径 φd1	首長 L2	全長 L	柄径 φd	刃数 N	形状
18	5	6.5	15	60	18	12	B
20	0.4	6.5	17.6	60	20	12	A
20	0.5	6.5	17.5	60	20	12	A
20	0.6	6.5	17.4	60	20	12	A
20	0.7	6.5	17.3	60	20	12	A
20	0.8	6.5	17.2	60	20	12	A
20	0.9	6.5	17.1	60	20	12	A
20	1	6.5	17	60	20	12	A
20	1.1	6.5	16.9	60	20	12	A
20	1.2	6.5	16.8	60	20	12	A
20	1						